

\*\* EL VARIES AT DUPONT'S PUMPING STATION, SEE CROSS SECTION DWG. 30MS461K510-3.

TYPICAL SECTION

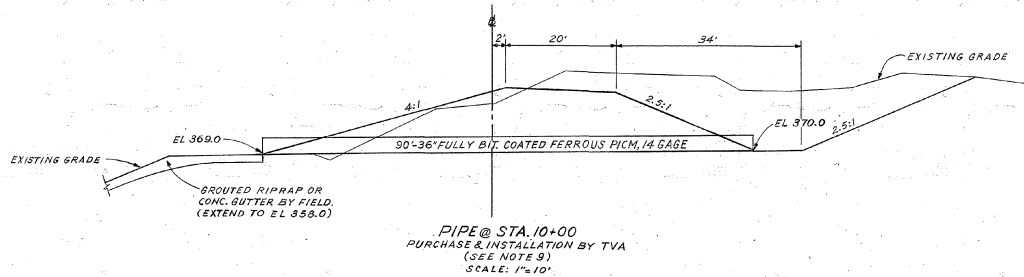

PIPE @ STA. 10+00  
PURCHASE & INSTALLATION BY TVA  
SCALE: 1\"/>

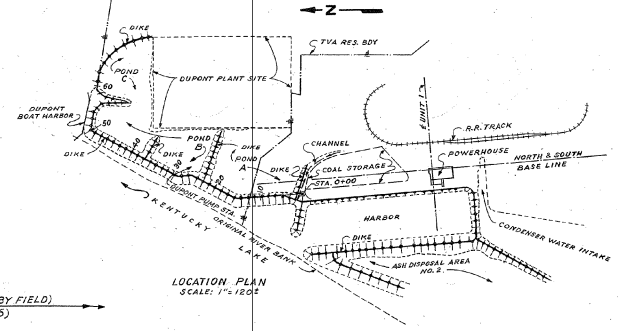

LOCATION PLAN  
SCALE: 1\"/>

- NOTES:
1. ALL WORK SHALL BE DONE IN ACCORDANCE WITH THE HWY 71 SPEC, EXCEPT AS NOTED.
  2. DIKE FILL SHALL CONSIST OF EITHER MATERIAL REMOVED FROM THE OUTSIDE OF THE DIKE WHILE FLATTENING THE SLOPE OR EARTH BORROW FROM AN EXISTING BORROW AREA NORTHEAST OF POND C. EXCAVATION FROM INSIDE THE PONDS SHALL NOT BE USED AS DIKE FILL AND SHALL BE DISPOSED OF IN EITHER POND A OR B.
  3. DIKE FILL SHALL BE THOROUGHLY COMPACTED WITH SHEEPSFOOT ROLLERS OR LOADED RUBBER-TIRED HAULING EQUIPMENT. FILL SHALL BE IN 6\"/>
  - 4. DURING THE EXCAVATION TO REMOVE THE NORTH DIKE OF POND B FROM OVER DUPONT'S BURIED WOOD FLUME, DEAD REPRESENTATIVES SHALL BE PRESENT. IF UNSUITABLE MATERIAL IS EXPOSED DURING THE EXCAVATION, OVER-EXCAVATION OF THIS MATERIAL AND REPLACING IT WITH COMPACTED EARTH BORROW WILL BE REQUIRED.
  - 5. A MINIMUM OF 4 INCHES OF SOIL SHALL BE PLACED, PER SECTION 142, ON ALL AREAS TO BE GRASSED. AS MUCH AS IS PRACTICAL, THIS SOIL SHALL BE OBTAINED FROM THE MATERIAL DEPOSITED IN POND B BY DUPONT DURING DREDGING OPERATIONS FOR THEIR BOAT HARBOR NORTH OF POND B. IF ENOUGH SOIL IS NOT AVAILABLE FROM THIS SOURCE, ADDITIONAL SOIL SHALL BE OBTAINED FROM THE BORROW AREA NORTHEAST OF POND C.

- NOTES CONT'D
6. EXCEPT FOR THAT PORTION OF POND B BEING USED BY DUPONT FOR DISPOSAL OF SLUDGE MATERIAL AND THAT PORTION OF POND A BELONGING TO DUPONT, ALL DISTURBED AREAS IN PONDS A AND B, INCLUDING THE DRAINAGE CONTROL DITCH AND ALL DIKE SLOPES, SHALL BE SEEDED, FERTILIZED AND MULCHED IN ACCORDANCE WITH SECTIONS 180 AND 182 RESPECTIVELY. THE FLAT SLOPE AT THE OUTSIDE TOE OF THE DIKE BETWEEN EL 360.0 AND EL 365.0 SHALL BE SEEDED THIS FALL WITH ANNUAL RYE, 50 LBS PER ACRE, AND THEN RESEEDED WITH TYPE 4 MIXTURE AND FERTILIZED NEXT SPRING. ALL OTHER AREAS SHALL BE SEEDED WITH TYPE 7 MIXTURE THIS FALL.
  7. WILLOW CUTTINGS SHALL BE PLANTED AT THE TOE OF THE DIKE BETWEEN EL 360.0 AND EL 365.0. THE WILLOW CUTTINGS SHALL BE PLANTED 4 FT. ON CENTER EACH WAY.
  8. THE ENTIRE WIDTH OF THE TOP OF THE DIKE SHALL BE SURFACED WITH 4 INCHES OF CRUSHED STONE OR GRAVEL PER SECT. 210.
  9. DUPONT WILL PURCHASE AND INSTALL DRAINAGE PIPES AT STATIONS 22+30, 24+60, 37+50, AND 47+50. INLET INVERT ELEVATION AT ALL PIPES SHALL BE 370.0. DUPONT WILL PROVIDE END PROTECTION TO CONTROL EROSION AT THE INLET AND OUTLET ENDS OF THESE PIPES.

NOT TO SCALE  
EXCEPT AS NOTED

MAIN PLANT		
SITE GRADING AT ASH DISPOSAL AREA		
JOHNSONVILLE STEAM PLANT TENNESSEE VALLEY AUTHORITY DIVISION OF ENGINEERING DESIGN		
SUBMITTED <i>J. M. Nelson</i>	RECOMMENDED <i>R. D. ...</i>	APPROVED <i>...</i>
KNOXVILLE 1-4-75 30 C 4 104443 R 1		
RECORD DRAWING AS CONSTRUCTED		

COMPANION DRAWINGS: 30MS461K510-1 THRU 7  
(CROSS SECTIONS)

NO.	DATE	BY	CHKD	APP	DESCRIPTION
1	10/10/75	JMN	...	...	GENERAL REVISION